

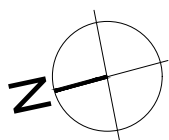

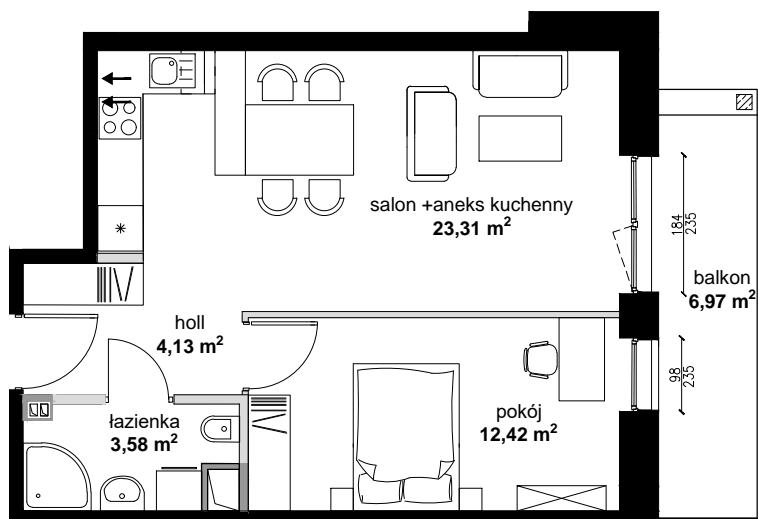

położenie mieszkania  
w budynku





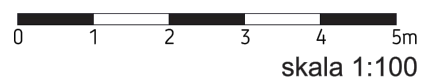

-  ściana działowa, możliwa przebudowa
-  szacht instalacyjny, brak możliwości przebudowy
-  ściana nośna, brak możliwości przebudowy



<b>BUDYNEK</b>	<b>B4</b>
<b>NUMER LOKALU</b>	<b>31</b>
<b>TYP</b>	<b>2P+AK</b>
<b>PIĘTRO</b>	<b>6</b>
<b>POWIERZCHNIA</b>	<b>43,44 m<sup>2</sup></b>

#### BIURO SPRZEDAŻY:

-  ul. Zemborzycza 112, 20-445 Lublin
-  795 146 706
-  biuro@wieniawaresidence.pl
-  www.wieniawaresidence.pl